



Painting

Equipment & Supplies

LKQ Refinish



From prep to final coat, LKQ Refinish provides everything you need to keep production moving, tools maintained, and finishes pristine.

LKQ Refinish

FOLLOW US! [!\[\]\(99f58673407353e96a019fbca558fd72_img.jpg\)](#) [!\[\]\(2113e5cba4d11862fa536c379e9b61cd_img.jpg\)](#) [!\[\]\(c9a5cd0ae2be6c3d63effa266a341339_img.jpg\)](#) [!\[\]\(068cc37fea7b7e82ca55b0672b7cbfba_img.jpg\)](#) [!\[\]\(f5ea5fed6e5d4d5703346c719029156e_img.jpg\)](#)

INDEX

PAINTING PRODUCTS & EQUIPMENT

Spray Equipment & Accessories	4
<i>Spray Gun Cabinets & Holders.....</i>	<i>6</i>
<i>Spray Gun Repair Kits</i>	<i>8</i>
<i>Air Regulators & Gauges</i>	<i>10</i>
Surface Prep Tools & Accessories	11
<i>Gun Washers & Cleaning Kits</i>	<i>11</i>
<i>Tack Cloths</i>	<i>13</i>
<i>Paint Prep Bottles and Towels</i>	<i>15</i>
<i>Touch-Up Bottles & Brushes</i>	<i>16</i>
Refinish Tools & Repair Accessories	18
<i>Panel & Bumper Stands</i>	<i>18</i>
<i>Door / Hood / Fender Stands</i>	<i>19</i>
<i>Parts Carts</i>	<i>20</i>
<i>Paint Shakers</i>	<i>21</i>
Consumables & Miscellaneous	22
<i>Stir Sticks</i>	<i>22</i>
<i>Strainers & Filters</i>	<i>22</i>
<i>Inline filters</i>	<i>23</i>
<i>Magnets & Panel Holders</i>	<i>23</i>
<i>Hard Cups</i>	<i>24</i>
<i>Mixing cups</i>	<i>26</i>
<i>Pressure Pot Kits & Liners</i>	<i>27</i>
Digital & Measurement Tools	28
<i>Colorimeters / Spectrophotometers</i>	<i>28</i>



3M

Performance Spray Gun w/ PPS™ 2.0

3M™ Performance Spray Gun System with PPS™ 2.0 combines our 3M™ Performance Spray Gun with HVLP Atomizing Heads.

Part #	Description
--------	-------------

MMM26778	Performance Spray Gun System w/PPS 2.0
----------	--



3M

Performance Fine Spray Gun System

3M™ Performance Fine Finish Spray Gun System uses 3M™ Performance Fine Finish Nozzles to spray some of the most-challenging coatings, helping perfect your color match and lay down clear coats like glass.

Part #	Description
--------	-------------

MMM26978	Performance Fine Finish Spray Gun System
----------	--



3M

Performance Spray Gun

Lightweight and easy to use, the 3M™ Performance Spray Gun was built for the modern painter. Capable of spraying a wide range of coatings from either a pressure-fed source or attached gravity cup, its impact-resistant composite body makes it one of the lightest spray guns available.

Part #	Description
--------	-------------

MMM26832	Performance Spray Gun
----------	-----------------------



3M

Performance Spray Gun 2

3M™ Performance Spray Gun 2 is the next generation of the 3M™ Performance Spray gun; a very versatile spray gun built for the modern painter. Its optimized design with a sleek gun frame, laser marked control knobs and redesigned comfort trigger help to provide an enhanced spraying experience.

Part #	Description
--------	-------------

MMM26852	Performance Spray Gun 2
----------	-------------------------



Gravity HVLP Atomizing Head

Part #	Description
MMM26709	HVLP Atomizing Head - White 0.9
MMM26712	HVLP Atomizing Head - Blue 1.2
MMM26713	HVLP Atomizing Head - Green 1.3
MMM26714	HVLP Atomizing Head - Orange 1.4
MMM26716	HVLP Atomizing Head - Purple 1.6
MMM26718	HVLP Atomizing Head - Clear 1.8
MMM26720	HVLP Atomizing Head - Red 2.0



Gravity Fine Atomizing Head

Part #	Description
MMM26909	Fine Atomizing Head - White 0.9
MMM26911	Fine Atomizing Head - Yellow 1.1
MMM26912	Fine Atomizing Head - Blue 1.2
MMM26913	Fine Atomizing Head - Green 1.3
MMM26914	Fine Atomizing Head - Orange 1.4
MMM26916	Fine Atomizing Head - Purple 1.6
MMM26918	Fine Atomizing Head - Clear 1.8
MMM26920	Fine Atomizing Head - Red 2.0



PPS™ Series 2.0 Adapters

Part #	Description
MMM26003	Type S2c, 16 mm Female, 1.5 mm Thread
MMM26016	Type S9, 16 mm Male, 1.5 mm Thread
MMM26046	Type S15, 3/8 Male, 19 Thread BSP
MMM26135	Type S40, Trapezoidal Thread
MMM26139	Type S43, 1/4 Male, 19 Thread BSP



Performance Spray Gun Rebuild Kits & Parts



Part #	Description
MMM26832	Performance Spray Gun Rebuild Kit
MMM26833	Performance Spray Gun Pressure Whip
MMM26842	Performance Spray Gun Poppet
MMM26838	Performance Spray Gun Needle
MMM26835	Performance Spray Gun Locking Collar
*MMM26841	Performance Spray Gun O-Ring Kit



Innovative Spray Gun Cabinet Deluxe

The door is designed to flip up and stay out of your way, and the digital cabinet lock will keep your expensive spray guns safe and secure. Inside, the cabinet holds up to six spray guns, and the mounting bar underneath the cabinet holds three more spray guns with cups.

Part # - INNISGCD



Innovative Spray Gun Cabinet

The door is designed to flip up and stay out of your way, and the digital cabinet lock will keep your expensive spray guns safe and secure. Inside, the cabinet holds up to six spray guns.

Part # - INNISGCD



Innovative Multiple Spray Gun Holder

Securely store up to seven spray guns in one organized, wall-mounted location. Built from heavy-duty steel with a durable powder-coat finish, this unit mounts directly to the wall with included fasteners to keep your spray guns protected & securely stored.

Part # - INNSSPCB



8-Position Gunshelf™

Hang up to 8 spray guns with or without a disposable cups and/or air blowers with the 8-Position GunShelf. Perfect for mixing rooms or anywhere many spray guns are stored.

Part # - KAR71082



KARAJEN®

Single Spray GunHanger™

Conveniently store your spray guns with the Single Spray GunHanger™ by Karajen Corp. Hang your spray guns or other tools safely and securely wherever you need them. Magnetic mounting or with fasteners.

Part # - KAR14024



KARAJEN®

Double GunHanger™

The Double GunHanger™ hangs up to two spray guns. Hanger slots are sized at 7/8" width to accommodate for most disposable cup systems. Slots hang the guns from the cup adapter, with or without the plastic cup.

Part # - KAR14774



KARAJEN®

BoothBox™ Mini

Keep your needed items close at hand and protected from overspray damage. The BoothBox™ Mini stores your tape, tack rags, razor blades, dirt pick tools, blow gun, touch up brushes and other items within reach.

Part # - KARKRJ15005



KARAJEN®

BoothBox™ 2

The BoothBox 2™ is a magnetic, double-compartment cabinet and double spray gun holder, designed for the interior of paint booths. With the BoothBox 2, you can store commonly used supplies within arm's reach.

Part # - KAR14008



DEVILBISS

Spray Gun Repair Kit - Tekna & SRiPRO

An official Spray Gun Repair Kit designed to rebuild TEKNA and SRiPRO series paint spray guns.

Part # - DEV702736

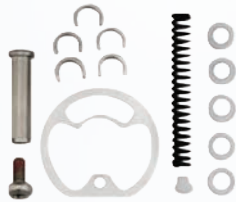

DEVILBISS

Spray Gun Repair Kit - Tekna ProLite

It restores peak spraying performance, consistent atomization, and precise fluid control by replacing worn internal wear parts.

Part # - DEV702736



SATA
German Engineering

X5500 Maintenance Set

Rebuild kit for SATAjet X 5500. Air cap ring seal, sealing element for fluid tip, air piston packing & holder, air piston head and rod, needle packing & holder, seals, spring, screws.

Part # - SAT1173286



SATA
German Engineering

1500B Maintenance Set

Rebuild kit for SATAjet 1500 B SoLV. Air cap ring seal, sealing element for fluid tip, air piston packing & holder, air piston head and rod, needle packing and holder, seals, spring, screws, air distribution ring & puller.

***Part # - SAT173278**



SATA
German Engineering

100B & 1000B Maintenance Set

What you need to rebuild your SATAjet 1000B or 100B. Air cap ring seal, sealing element for fluid tip, air piston packing & holder, air piston head and rod, needle packing and holder, seals, spring, screws, air distribution ring & puller.

Part # - SAT1173260



German Engineering

5000B Maintenance Set

Slimmed down maintenance sets, what you need to rebuild your SATAjet 5000. Air cap ring seal, sealing element for fluid tip, air piston packing & holder, air piston head and rod, needle packing and holder, seals, spring, screws, air distribution ring & puller.

Part # - SAT1050674



German Engineering

4000B Maintenance Set

What you need to rebuild your SATAjet 4000. Air cap ring seal, sealing element for fluid tip, air piston packing & holder, air piston head and rod, needle packing and holder, seals, spring, screws, air distribution ring & puller.

Part # - SAT1047837



German Engineering

Jet X Repair Set

Genuine SATA repair set.

Part # - SAT1203562



German Engineering

Spray Gun Maintenance Kits

Be perfectly equipped with Genuine SATA accessories and spare parts.

Part #	Description
--------	-------------

*SAT64035	Spray Gun Maintenance Kit
*SAT64036	MiniJet Air Brush Maintenance Kit



THE SPRAY GUN PEOPLE

Spray Gun Lube

Spray gun lube (0.25 oz, pack of 6), keep spray gun operating smoothly.

Part # - SHA8255



1/4" NPT Brass Regulator

Lightweight, durable brass construction that resists rust, cold, and heat. Control: Smoothly adjusts air pressure from closed ("0") to fully open ("MAX") without needing to walk back to the compressor.

Part # - AES203



Astro Pneumatic

Air Regulator with 160lbs Gauge

Provides fine air control for spray guns and air tools. Swivel top allows for easy installation. Fits any spray gun or air tool.

Part # - ASTWS11



DEVILBISS

High Output Air Adjusting Valve Regulator With Gauge

Includes markings for the optimal operating range for the Devilbiss GTI Millennium, and GFG Plus Gun. Precise air control at the gun for best, consistent results Impact resistant gauge and break resistant lens. Lightweight design that fits and professional spray gun.

Part # - DEVHAV511



SATA

German Engineering

Pressure Regulator with Gauge

The SATA high quality air micrometer indicates precise HVLP, RP or conventional air pressure settings at the spray gun air inlet. The gauge bezel has a green color coded pressure range for correct adjustment of SATA HVLP guns and blue for SATA RP.

Part # - SAT27771



SATA

German Engineering

Adam 2 U Air Micrometer

Available in black. With the SATA adam 2 U, all other types of guns can be also digitized: The SATA dry jet blow gun as well as all spray guns of other makes. The adjustment screw on the side of the SATA adam 2 dock allows to set the pressure precisely.

***Part # - SAT1031731**



QMR Jet X

This material flow regulation device allows to preset the required reduced material flow rate which can then be activated quickly, precisely and in reproducible fashion at the push of a button. The 'release function' allows convenient switch back to the fully open position within seconds.

Part # - SAT1202019



AdamXPro, Non-Basic Jet X

Equipped with the QAC (Quick Adam Connector) the adam X pro offers an unprecedented range of digital functions. The data analysis helps the painter to improve and optimize results, data can be transferred to a digital dashboard on a laptop, smart phone or tablet.

Part # - SAT1202001



17 PC Spray Gun Cleaning Kit

Complete Spray Gun Cleaning Kit offers a variety of essential tools for cleaning most spray guns. Safe for use with harsh chemicals, acids and solvents thanks to the special coated brush handles.

Part # - AES208



12 PC Spray Gun Cleaning Kit

Cleaning Kit offers a variety of basic tools for cleaning most spray guns. Safe for use with harsh chemicals, acids and solvents thanks to the special coated brush handles.

Part # - AES212



Basic Spray Gun Cleaning Kit

Cleaning Kit contains three simple, yet effective brushes for cleaning your spray gun.

Part # - AES210



Astro Pneumatic

12 PC Master Spray Gun Cleaning Kit

Designed to keep your spray guns clean and in good working condition. Use with any thinners or solvents, helps clean away paint residue and sludge, specially designed for use with HVLP system.

Part # - AST9013



ATD

20 PC Master Spray Gun Cleaning Kit

This kit contains a variety of brushes and picks which can be used to remove paint from spray guns and cups.

Part # - ATD6848



FINISHMASTER
BY LKQ

Spray Gun Cleaning Solution

Part #	Description	Volume
FMBH20A	Manual Gun Cleaning Solution	11 Oz
FMB5-G	Gun Wash	1 Gallon
FMB5-5G	Gun Wash	5 Gallon
FMB5-16G	Gun Wash	16 Gallon
FMB5-55G	Gun Wash	55 Gallon
FMB11-G	Low VOC Gun Wash	1 Gallon
FMB11-5G	Low VOC Gun Wash	5 Gallon



herkules

G200 Paint Gun Washer

Automatically cleans 2 guns and 2 cups in one minute. This washer requires only five gallons of mid to high grade solvent about every four to six weeks.

Part # - HERG200



Cleaning Kit Spray Gun

Kit contains all necessary brushes and tools to effectively clean spray guns including new HVLP paint spray guns. Can also be used to clean gravity feed, siphon and undercoating guns. Safe to use with chemicals and solvents.

Part # - UNIGCTOOLS



18 PC Master Spray Gun Cleaning Kit

Designed to keep your spray guns clean and in good working condition. Use with any thinners or solvents, helps clean away paint residue and sludge, specially designed for use with HVLP system.

Part # - UNIGCTOOLS



E50 Manual Flex Waterborne Spray Gun Cleaner

Delivers equivalent superior cleaning performance to our larger models. This system is compatible with many optional upgrades. It can be outfitted with a leg-kit, offers mount-ability or set it on a wheeled-cart to maximize versatility.

Part # - BECE50MHEN



Surgical Blue Tack Cloth

Delivers equivalent superior cleaning performance to our larger models. This system is compatible with many optional upgrades. It can be outfitted with a leg-kit, offers mount-ability or set it on a wheeled-cart to maximize versatility.

Part # - ABP15801



Premium Tack Cloths

Tack Cloths, Bond Crystal Brand 18" x 36" 12 Cloths Per Box. Product Features. Will not dry-out, harden or darken. Spontaneous combustion proof. Designed to leave no residue.

Part # - CRYPREMA



Perfect Poly Tack Cloths

Crystal Tack Cloth (Perfect Poly) is well suited for waterborne applications. High-quality materials, application-specific formulas and tight specification manufacturing process. Exclusive 'thermoset' process that significantly reduces invisible residue buildup.

Part # - CRYPREMAPOLY



GERSON

Cotton Tack Cloth

100% Bleached Cotton Gauze Substrate. Soft cotton mesh material contours to surface shapes. Completely removes surface particulates without leaving harmful residue. Wax and Silicone-Free.



Part #	Description	Size
GER020001G	Cotton Tack Cloth - Gold	18"x36"
GER020001W	Tack Cloth - White	20"x12"
GER020002B	2000 BC Tack Cloth	18"x36"
GER020002R	Tack Cloth - Orange	20"x16"
GER020002W	Tack Cloth - White	20"x16"
GER020003G	Tack Cloth Deluxe Gold	18"x36"
GER020004G	Tack Cloth Gold Supreme	18"x36"
GER020008B	Blend Prep XI Dry Tack	18"x36"
GER020008B-EA	XI Tack Cloth - Blue	18"x18"
GER020008G	Ultra Prep Tack Cloth 18x18	18"x18"
GER020009C	Tack Cloth	18"x36"
GER020009C-EA	Tekprep XI Tack Cloth	18"x18"
GER02001B	Tack Cloth Blue Blend Bc/Cc	18"x36"
GER02008C	Perfect Blend Prep Wipe Blue	18"x18"



Magnum Blue Tack Cloth

Ultra-soft, anti-static, non-abrasive tack cloths in a convenient pop-up design that can be used to collect dust, dirt and lint on a variety of surfaces. Wax and silicone-free. 18" x 36"

Part # - USC60075-EA



Premium Prep Work Wipes

Virtually lint-free paint shop wipes are exceptionally strong and highly absorbent. Ideal for critical task work in paint booth and prep areas. Blue wipes are designed for use in solvent-borne systems. White wipes are waterborne compatible.

Part #	Description	Color	Sheet Qty.	Sheet Size
FMB61102	Jumbo Roll	White	-	9" x 13"
FMB86884	Center-Pull Roll	White	-	9" x 15"
FMB1017	1/4 Fold Poly Pack	Blue	-	11"x 13"
FMB86884	Center-Pull Roll in Tote	Blue	-	9" x 12"
FMB4SB	Pop-Up Box	Blue	80	12" x 17"
FMB1019	Center-Pull Roll in Tote Box	Blue	240	9" x 24"
FMB95102	1/4 Fold, Dispenser Box	Blue	250	12" x 17"
FMB93102	1/4 Fold Dispenser Box	White	250	12" x 17"



Specialty Towels & Wipes

Reusable cloth-like towels (ideal for rag replacement), are solvent resistant (won't breakdown in aggressive solvents), have superb wet strength and wipe dry performance, are highly absorbent (in aqueous liquids, oil and solvents), are chemically pure (binder and contaminant free), and are virtually lint free.



Part #	Description	Sheet Qty.	Sheet Size
MDI93012B	White Spunlace Prep Towel	50	12" x 13"
MDI95012B	Blue Spunlace Prep Towel	50	12" x 13"
MDI95119	Super Prep Towel Blue	250	9" x 12"



Microfiber Towels

Blue 15" x 15" Microfiber towel for detail wiping.

Part # - FMBBLUE



Microfiber Towels

Trimaco's SuperTuff Blue Microfiber Wiper attracts and traps dust, is super absorbent, lint-free, washable and reusable. Microfiber wiper is great for paint prep, general cleaning and automotive care.

Part # - TRI10824



Dry Jet 2 Blow Spray Gun

This practical, lightweight blow gun makes quick work of drying waterborne material. A special nozzle design multiplies air volume from ambient air using the Venturi injection principle. An air intake filter prevents contamination of the paint.

Part # - SAT217489



Solvent Pumps 5 & 55 Gallon

Plated Steel construction with a solvent resistant polyurethane internal seal guarantees outstanding performance with a long service life.

Part #	Description
AES716	55-Gallon Drum Pump
AES745	5-Gal Pail Pump



Solvent & Water Based Pump Sprayers

Designed for automotive detailing, including but not limited to brake cleaners, rust penetrants, de-waxers, and degreasers.

Part #	Description
FMB90PS	Solvent Based Pump Sprayer
FMB93PS	Water Based Pump Sprayer



Handy Pump Sprayer

Durable poly-construction design made with a comfort grip to spray surfaces with a variety of cleaners. Use for quick and easy application of surface cleaners.

Part # - USC70305



DeKups Squeeze Bottle - 16oz

Part # - DEVDPC8



E-Z Dabbers & Touch-Up Brushes

Part #	Description
EZM78000	E-Z Dabbers
EZM76000	Touch-Up Brushes



Touch-Up Bottles

Part #	Description
EZM10002-ZZ	Touch-Up Bottles
EZM10002	Touch-Up Bottles - 50 Qty



1930 Camel Brushes

Part #	Description
MAC1930	1930 Camel Hair Brush Set - 144 Qty
MAC1930OS2	1930 - No. 2 Camel Hair Brush
MAC1930OS3	1930 - No. 3 Camel Hair Brush



Innovative SuperStand 2

The Innovative SuperStand bumper repair stand boosts your profits by speeding up repair, prep, and painting times and reducing mistakes!

***Part # - INNSS2**



Innovative UltraRack

Paint the entire panel without ever putting the spray gun down. Spray the parts just like they fit on the vehicle for better color match and finish.

Part # - INNURPS



Innovative X-Stand

Repairs, painting, and storage. No stand does more! Perfect for door skin replacement & transferring bumper components.

Part # - INNIXS



Innovative Truck Bed Dolly

This versatile truck bed repair stand fits any size truck bed. Super adjustable, strong, stable, and stores with the smallest footprint.

Part # - INNSS6



Innovative Truck Bed Dolly

Variable Height Adjustment – 13 inches of vertical adjustment allows for a comfortable work level. Durable Finish – 4" Industrial grade Total Lock Caster Wheels keep unit in place, and collapses to 10" width.

Part # - INNITBD



Innovative Door / Fender Single

Spray panels just like they mount and line up on the vehicle for the best color and texture matches and no missed edges!

Part # - INNIDFS



Innovative Door / Fender Double

Securely holds fenders and doors in any combination allowing for complete paint coverage inside and out.

Part # - INNIDFD



Innovative Octopus Rack

Mount parts just as they fit on the vehicle. Consistent color and texture finish, every time. Don't miss edges ever again. Save Space in Your Booth.

Part # - INNOPR



Innovative SuperStand 6

The SuperStand 6 is the first and only universal mobile clamping system that securely holds the most difficult bumper covers in the world!

Part # - INNSS6



Innovative Parts Cart-B

Often imitated. Never duplicated. The Parts Cart B Series from Innovative Tools requires little space but brings big benefits.

Part # - INNSSPCB



Padded Stand

The thick padded panel rests tilt and lock securely in multiple positions, while the adjustment tubes let the technician set most-appropriate height for the repair. Locking caster wheels make it easy to transport and secure parts.

***Part # - MMM30134**



P.A.R.T.S. Holding Rack

Adjustable to 4 positions for optimal paint coverage. Tubular construction, rounded corners and pads protect panels from scratches and dings. Holds up to 200 lbs. in flat tabletop position to support a full range of parts and panels. Folds for easy, efficient storage.

Part # - MMM02514



C.A.R.T.S.

Three large storage shelves help organize tools and supplies. Sturdy metal construction provides durability. Rubber caster wheels allow technicians to keep cart within easy reach. Epoxy powder coating offers corrosion protection.

Part # - MMM02508



Cyclone Pneumatic Paint Shaker

This classic design and performance accommodates any half liter cans through gallon, aerosol and rectangular cans. Built in air pressure compensator with automatic lubricator to ensure your shaker is moving when needed.

Part #	Description
DUPM232	Cyclone Pneumatic Paint Shaker
DUPM233	Cyclone Pneumatic Shaker Pedestal



RotoGen 1000

The RotoGen 1000 paint mixer is especially designed for mixing small quantities of car refinish paint and delivers excellent mixing results. Therefore it helps to assure the ideal application of automotive coatings at auto body and collisions repair shops.

***Part # - COL34452**



MIX'N'SHAKE™

Automated stirring technology is designed to eliminate traditional manual stirring methods in the automotive refinish industry. The system, which is available globally, improves paint mix consistency, reduces consumable waste and saves time for painters and body shops.

Part # - SEM93090

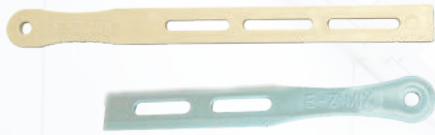

Mixing Sticks

Part #	Description
EZM12100PK10-EA	12" Plastic Stir Stick
EZM85100-EA	8" Plastic Stir Stick

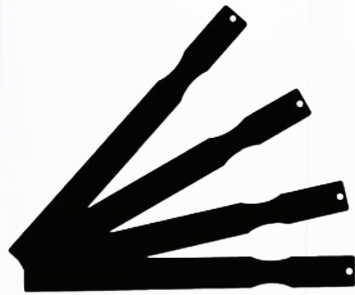

Mixing Sticks

These paddles are designed for efficient mixing, ensuring consistent paint application every time, reducing the risk of uneven coats or wasted materials in the mixing process.

Part # - GLE2100

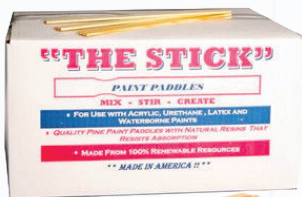

Paint Paddle

Quality Pine Paint Paddles With Natural Resins that resists absorption. Made from 100% renewable resources. 1000/Case.

Part # - TEN070010



DEVILBISS

190 Micron Paint Strainer

No double meshed tip – eliminates unstrained paint passing through the tip. No contamination – all gluing and imprinting done on outside

Part # - DEV802351



GERSON

Paint Strainers

Part #	Description
GERSTRAINER	Poly Paint Strainers
GERO10614Y	Elite Strainer Fine Mesh 190 Micron
GERO10914B	Elite Strainer X-Fine Mesh



DEVILBISS

Disk Filters

Part #	Description
DEVDP42K24	Disk Filter 125 Mircon - 24/34oz
DEVDP65K24	Disk Filter 125 Mircon - 9 Oz
DEVDP66K24	Disc Filter 200 Micron - 24/34oz



ATD

3 Pc - Spray Gun Filter

Traps moisture, rust, scale and oil aerosols that pass through conventional filters. Max Flow - 80 psi.

***Part # - ATD7812**



SATA

German Engineering

Activated Charcoal Filter

***Part # - SAT71115189**



KARAJEN

Magnetic BoxHanger™

This innovative 2-piece Magnetic BoxHanger™ pierces into the sides of the box and attaches magnetically to the wall, so you can keep your materials clean and off the floor.

Part # - KAR54044



KARAJEN

Test Panel Holder™

Simplify your test panel/spray-out card process. Easily attach paper or metal test panels, then aim and spray! Save time and materials by eliminating the repetitive task of taping a test panel to a stir stick.

Part #	Description
KAR92002	Metal Test Panel Holder™ w/Clipboard
KAR92003	Metal Test Panel Holder™ W/o Clipboard
*KAR93013	Metal Test Panel - 10 Qty



DEVILBISS

Disposable Paint Cups

Part #	Description
DEV802100	34oz - Disposable Paint Cup Kit
DEV802102	9oz - Disposable Paint Cup Kit



DEVILBISS

DeKups Evo Kit

Part #	Description
DEV802228	34oz - DeKups Evo Cup Kit
DEV802222	9oz - DeKups Evo Cup Kit

Smart

SMART Paint Cup System

The system features a conventional collar with secure, smooth threading that ensures a tight seal, along with strengthened locking clips designed to provide greater stability during attachment.



Part #	Description	Micron
SMTSPCSL850200	Large 850mL - Lids & Liners	200
SMTSPCSR650200	Regular 650mL - Lids & Liners	200
SMTSPCSM400200	Medium 400mL - Lids & Liners	200
SMTSPCSS200200	Small 200mL - Lids & Liners	200
SMTSPCSL850125	Large 850mL - Lids & Liners	125
SMTSPCSR650125	Regular 650mL - Lids & Liners	125
SMTSPCSM400125	Medium 400mL - Lids & Liners	125
SMTSPCSS200125	Small 200mL - Lids & Liners	125
SMTSPCSL850CUP	Large 850mL - Hard Cup & Collar	-
SMTSPCSR650CUP	Regular 650mL - Hard Cup & Collar	-
SMTSPCSM400CUP	Medium 400mL - Hard Cup & Collar	-
SMTSPCSS200CUP	Small 200mL - Hard Cup & Collar	-



LCS & RPS Cup Kits

Part #	Description
SAT1010389	125m Flat Sieve Std Ld - .3l Cup
SAT1010397	200m Plug In Sieve Std - .3l Cup
SAT1010438	125m Flat Blue Sieve - 0.6l Cup
SAT1195818	Lcs Cup 0.40l Kit - 125m Sieve
SAT1195826	Lcs Cup 0.40l Kit - 200m Sieve
SAT1195834	Lcs Cup 0.65l Kit - 125m Sieve
SAT1195850	Lcs Cup 0.65l Kit - 200m Sieve
SAT1202043	Rps Cup Flat Sieve - .3l/125m
SAT1202077	Rps Cup Plug-In Sieve - .3l/200m
SAT1202100	Rps Cup Flat Sieve - .6l/125m
SAT1202134	Rps Cup Plug-In Sieve - .6l/200m
SAT1202142	Rps Uv Cup Flat Sieve - .6l/125m
SAT1202150	Rps Uv Cup Plg-In Sve - .6l/200m
SAT1202259	Rps Cup Flat Sieve - .9l/125m
SAT1202267	Rps Cup Plug-In Sieve - 09l/200m
SAT1214816	Rps Cup Flat Sieve - .3l/125m
SAT1214824	Rps Cup Plug-In Sieve - .3l/200m

VCS™ Versatile Cup System Kits

Part #	Description
SEM92112	VCS 22oz Hard Cup Blank
SEM92122	VCS 13oz Hard Cup Blank
SEM92132	VCS 32oz Hard Cup Blank
SEM92200-CS	VCS 32oz Liner;4-50/Packs
SEM92210	VCS 22oz Liner - 50 Pack
SEM92220	VCS 13oz Liner - 50 Pack
SEM92300	VCS 125 Micron Lid With Cap
SEM92720	VCS 125 Micr Hard Cup Kit - 13oz
SEM92730	VCS 125 Micr Hard Cup Kit - 22oz



PPS™ Series 2.0 Vented Spray Cup Kit

Part #	Size	Micron
MMM26264	Large (32.1 fl oz, 950mL)	200
MMM26263	Standard (23.7 fl oz, 700mL)	200
MMM26262	Midi (13.5 fl oz, 400mL)	200
MMM26261	Mini (8.5 fl oz, 250mL)	200
MMM26260	UV - Standard (23.7 fl oz, 700mL)	200
MMM26164	Large (32.1 fl oz, 950mL)	125
MMM26163	Standard (23.7 fl oz, 700mL)	125
MMM26162	Midi (13.5 fl oz, 400mL)	125
MMM26161	Mini (8.5 fl oz, 250mL)	125
MMM26160	UV - Standard (23.7 fl oz, 700mL)	125





E-Z MIX®
We Always Measure Up!



Mixing Cups & Lids

Part #	Description
EZM70003	14 Pint Cup Plastic
EZM70004	Ez Mix Cup - 1/4 Pint
EZM70008	Ez Mix Cup - 1/2 Pint
EZM70008L	Ez Mix Lid - 1/2 Pint
EZM70016	Ez Mix Cup - Pint
EZM70016L	Ez Mix Lid - Pint
EZM70032	Ez Mix Cup - Quart
EZM70032L	Ez Mix Lid - Quart
EZM70064	Ez Mix Cup - 2 Quart
EZM70064L	Ez Mix Lid - 2 Quart
EZM70086	Ez Mix Cup - 2 1/2 Quart
EZM70086L	Ez Mix Lid - 2 1/2 Quart
EZM70165	Ez Mix Cup - 5 Quart
EZM70165L	Ez Mix Lid - 5 Quart



Mixing Cups & Lids

Part #	Description
FMB908K	1/2 Pint Mixing Cup
FMB908L	1/2 Pint Mixing Cup Lid
FMB916	1 Pint Mixing Cup
FMB916L	1 Pint Mixing Cup Lid
FMB932	1 Quart Mixing Cup
FMB932K	1 Quart Mixing Cup
FMB932L	1 Quart Mixing Cup Lid
FMB932S	1 Quart Mixing Cup Smart Ratios
FMB932B	1 Quart Mixing Cup Blank
FMB932E	1 Quart Mixing Cup
FMB940	40 Oz Mixing Cup
FMB980	2.5 Quart Mixing Cup
FMB980L	2.5 Quart Mixing Cup Lid
FMB160	5 Quart Mixing Cup
FMB160L	5 Quart Mixing Cup Lid



Mixing Cups & Lids

Part #	Description
HITMC16	High Teck Mix Cup - 16oz
HITMC32	High Teck Mix Cup - 32oz
HITMC86	High Teck Mix Cup - 86oz
HITMC165	High Teck Mix Cup - 165oz



Mixing Cups & Lids

Part #	Description
KEY90032	Quart Mixing Cups 100 Per Case
KEY908K	Keystone Mixing Cup 8 Oz
KEY908L	Mixing Cup Lids;8oz
KEY916	Keystone Mixing Cup;Pint
KEY916L	Keystone Mixing Cup Lid;Pint
KEY9174	Keystone Mixing Cup 5 Qt
KEY9174L	Keystone Mixing Cup Lid 5 Qt
KEY932	Keystone Mixing Cup;32oz
KEY932E	Keystone Mixing Cups;32oz
KEY932K	Keystone Mixing Cups;32oz
KEY932L	Keystone Mixing Cup Lid
KEY940	Keystone Mixing Cup;40oz
KEY980	Keystone Mixing Cup 2.5 Qt
KEY980L	Keystone Mixing Cup Lid 2.5qt

Mixing Cups & Pails

Part #	Description
USC36170-EA	Poly Pail Mixing Cup - Pt
USC36174-EA	Poly Pail Mixing Cup - Qt
USC36176	Painter's Pail Cup - 2.5 Quart
USC36178	Painter's Pail Cup - 5 Quart
USC36182	Painter's Pail Cup - Half Pint



Pressure Pots & Liners

Part #	Description
BNK6239	Tank Liner For 83-5400
BNK6228	2 Gallon Tank Liner - 60 Qty
BNK6238	2 Gallon Performance Tank Liner
BNK80356	2 Quart Pot Liners - 12 Qty
BNKPT78	27 Gallon Tank Liner

AkzoNobel



Automatchic™ Vision

The compact, hand-held Automatchic spectrophotometer uses the latest digital technology for precise, reliable color measurements. It is easy to use and requires minimal training. To streamline processes, the latest version of Automatchic is wifi enabled.

Features

- **High Precision on Curved Surfaces:** The device features a compact measurement opening and guide pins, allowing you to easily read colors even on highly contoured bodywork.
- **Fast, Conclusive Readings:** It requires only two quick, conclusive readings to determine the exact color, dramatically reducing the need for time-consuming test spray-outs.
- **Massive Cloud Database:** When paired with AkzoNobel's MIXIT color retrieval software, painter gain instant access to a global database of over million colors and variants.
- **Wi-Fi and Mobile Connectivity:** The device seamlessly synchronizes with smartphones and tablets, allowing technicians to transfer color readings directly from the shop floor.



Irus Scan

Accurately detects and matches colors with metallic and pearlescent flakes Precisely captures hues that shift at different observation angles. Analyzes gloss levels for a complete color match. Provides real-time surface visualization for enhanced accuracy.

Accurate Color Every Time

From simple to the most complex colors, matches are made quickly and easily. That means faster repair times and higher levels of customer satisfaction.

Higher Productivity

Getting an accurate color match the first time, every time means faster workflow through the body shop which increases throughput and profitability.

Optimization of Skilled Labor

Easy to use, it does not require skilled technicians to operate. This keeps them productive in the paint booth, reducing unnecessary bottlenecks in workflow.

Reduced Waste

Accurate color, sparkle, and effect readings reduce the need for sprayouts, decrease rework, and ultimately lower product waste.

*Contact Your Local LKQ Representative For Details



Acquire™ Quantum EFX

The Acquire™ Quantum EFX spectrophotometer from Axalta is the most powerful, most effective color matching tool available today.

With WiFi connectivity and a compact design, the Acquire Quantum EFX has been designed to help you achieve the most accurate color match possible, even for complex pearl and effect colors - faster and easier than ever before.

The Acquire Quantum EFX looks deep into the paint film with advanced optics to acquire the flake and color characteristics that are the keys to determining the best color match.

Features

- Reads color and flake characteristics to get multiple dimensions of color
- Selects the best formula when more than one is available, to ensure the best match possible
- Bright touchscreen display can be seen in any light, even the strongest sunlight
- WiFi connectivity
- Built-in rechargeable battery
- Smart cradle that recharges and uploads data

Digimatch™

The new PPG spectrophotometer is the best of both worlds: small design plus enhanced technology. PPG DIGIMATCH™ has a functional ergonomic design that is lightweight and can be used with one hand, while also boasting a digital color camera packed with technology. The camera's six imaging angles, with additional six reflectance angles, provide texture information to help retrieve the correct formula matches, quickly and efficiently.

Features

- Intuitive 2.8-inch high-resolution touchscreen with large icons for easy navigation
- Docking station to charge and store spectro safely and dust free, holding the calibration tiles as well
- Portable, ergonomic and lightweight with the small form allowing users to maneuver into difficult areas on vehicles
- Multi-angle color spectrophotometer featuring 6 reflectance and 6 imaging angles, providing a magnified image to avoid defects when scanning

[*Contact Your Local LKQ Representative For Details](#)



**Stay Tuned for our
Spray Gun inventory**

DEVILBISS



DV1
BASECOAT

The DV1 Base coat

Equipped with an integrated digital gauge to provide precise inlet pressures for optimal gun performance and perfect color matching. The gauge is designed and placed in-line at eye-level for quick, easy checking – keeping it out of the way where it won't be covered by the painter's hand.



DV1
CLEARCOAT

The DV1 Clear coat

The DV1 Clear coat produces an even distribution of fine, uniformly sized particles that easily wet up a surface and flawlessly hang on vertical panels. Sprayers will instantly see an improved Distinctness of Image (DOI) and an overall brilliance in the reflective, mirror-like clear coat finish.



DV1S
REPAIR

The DV1 Repair

The DV1s Smart/Spot Repair gun features three all-new DV1s Smart/Spot Repair air caps, delivering superior high-efficiency performance for a perfect invisible repair finish. The DV1 air caps deliver consistent and uniform spray patterns to provide flawless, right first time results.

SATA

German Engineering



SATA jet X

Impresses with labyrinth airflow and X-nozzle system, providing fine, homogeneous and almost pulsation-free atomization. Digital precision for exact pressure adjustment and reproducibility: The adam X pro digital unit displays the inlet pressure, allows setting a target value, and provides a visual warning for deviations of 0.2 bar or more. It also measures temperature and application time, linking all data to a digital dashboard. 3 in 1 - air inlet with swivel joint combined with a new, innovative air micrometer for even more precise adjustment of the inlet pressure. Tool-free removable trigger guard with integrated fluid-tip spanner - the tool that's always at hand for quick removal and assembly of the fluid tip. Its low weight (26 grams lighter than its predecessor), combined with improved ergonomics allows for more comfortable, fatigue-free application.



[Click the Catalogs to Learn More.](#)

FOLLOW US!



LKQ Refinish